

## A New Building for **GUDALUR ADIVASI HOSPITAL**

From a state of abject helplessness-“lying down to die”, the tribals are now confidently seeking health care as their fear is fast disappearing.

Through a health programme that is owned by the tribal community. Staffed almost entirely by tribals.

Probably the only one of its kind in India.

The tribals' dream of having a new building for their hospital - better designed and well-equipped.

**You can help make this dream a reality !**

Our vision is to establish a health system with 8 Area Centres providing primary and preventive health care and the Gudalur Adivasi Hospital for secondary care.

Today, over 14000 people are accessing the health services. Over 100 tribal youth are working closely with their community delivering various services. They are supported by about 200 tribal volunteers.

We are close to achieving our vision. What we have today is the culmination of efforts initiated 20 years ago...

See [www.ashwini.org](http://www.ashwini.org) for more details on the evolution of the programme.

### **The Changing Trends**

Hospital Deliveries

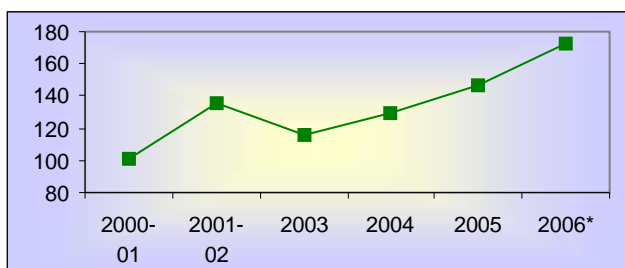

\* Till Nov. 06

Out Patients

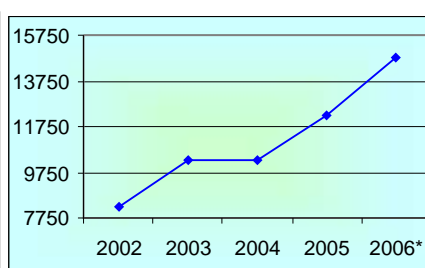

\* Till Nov. 06

In Patients

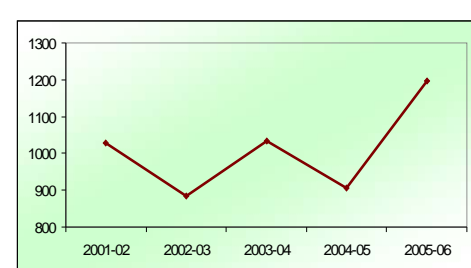

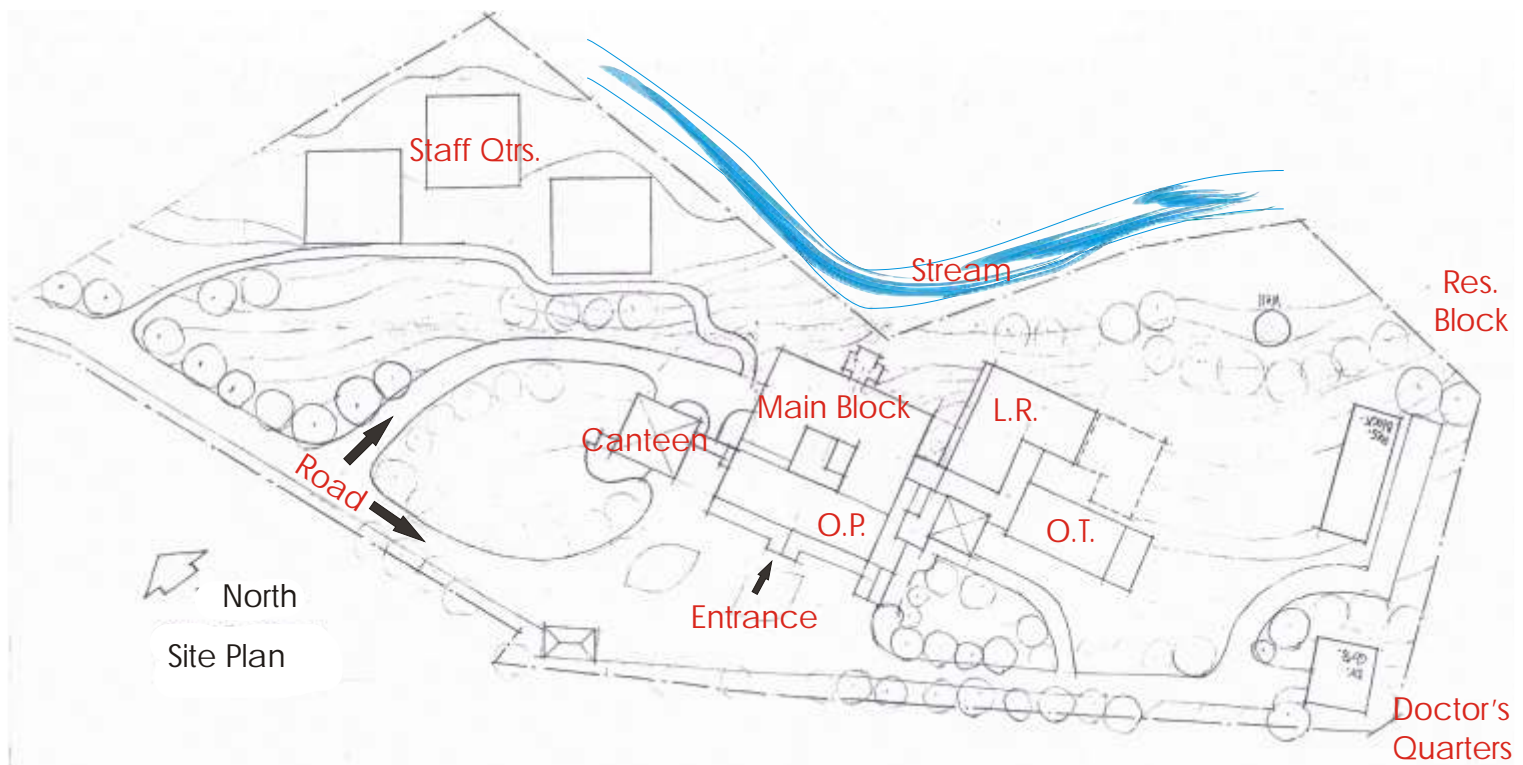

Back in 1992 a 2 ½ acre plot of land, at the foot of the mountains with a stream flowing through it, was acquired and a hospital building designed. This plan had to be shelved for various reasons.

The ACCORD office building was modified to serve as the hospital. This is now proving to be totally inadequate and there is a pressing need for a better equipped, better designed building.

### **The Plan**

The main block will house OP, wards, investigative unit and ICU in 2 levels - a basement and a ground floor. A third upper level will house the offices. The Labour and Delivery rooms (LR) and the Operating Rooms (OT) will be in 2 smaller blocks.

The total area works out to about 13500 sq.ft. and circulation space of 2850 sq feet. The estimated cost of constructing this new hospital building is Rs. 8,800,000 (about \$195,000)

The canteen and staff quarters in an area of about 5200 sq feet. The cost of this is estimated to be Rs.3,100,000 (about \$ 69,000).

### **To contribute to the Building Fund :**

In the US, for tax deductible donations on line, go to [www.ashwini.org](http://www.ashwini.org) and click on Donations.

Checks (tax deductible) can be made out to Vidyalay.org Foundation Inc and mailed to Ms. Asmita Shendye, 35 Meyer Drive, Clifton, NJ 07012

In the UK, checks can be made out to Charities Advisory Trust , Radius Works, Back Lane, Hampstead, London NW31HL. Donations can be “ gift aided”.

(Please mention that the donations are for ASHWINI).

Checks from donors in India and other countries can be mailed directly to  
ASHWINI, P.O.Box 20, Gudalur-643212, Nilgiris, Tamilnadu.  
INDIA

Donations in India are tax exempt under Section 80G of the Income Tax Act.

